



490 GRAND SEDAN



INTEGRITY
MOTOR YACHTS

DISCOVER MORE

PART OF THE WHITEHAVEN MOTOR YACHTS FAMILY



WHITEHAVEN
MOTOR YACHTS

DISCOVER MORE



WELCOME TO INTEGRITY MOTOR YACHTS

The classic 'holiday home on water', Integrity Motor Yachts are the 'go anywhere' boats that inspire owners to "Discover More".

Comprising Sedan, Flybridge and Pilot House models, Integrity Motor Yachts are designed and built to deliver exceptional performance at sea, with all the lifestyle attributes for laid-back entertaining.

Low maintenance, hardy, stable and ideal for long-range or coastal cruising, Integrity Motor Yachts are supported by a reliable Dealer network committed to outstanding levels of personalised service, fully-backed by factory warranties for complete peace of mind.

From layout to interior design and décor, your Integrity is one of a kind, thanks to the collaborative approach of the Integrity team.

Whatever your cruising dreams, Integrity can craft the ideal vessel to fulfil your needs.



INTEGRITY
MOTOR YACHTS

DISCOVER MORE

340SEDAN

340SX

380SEDAN

380SX

380FB

440SEDAN

440FB

460SX

490GRANDSEDAN

510SX

QUEENSLAND
Integrity Motor Yachts
Jason Kowalski 0416 057 326

NEW SOUTH WALES
AWMarine Sales
Adam Workman 0419 124 939

VICTORIA
Pier 35 Boat Sales
Terry Ryan 0422 666 212

WESTERN AUSTRALIA
Martin Box Marine
Phone 08 9336 1466

www.integrityboats.com.au

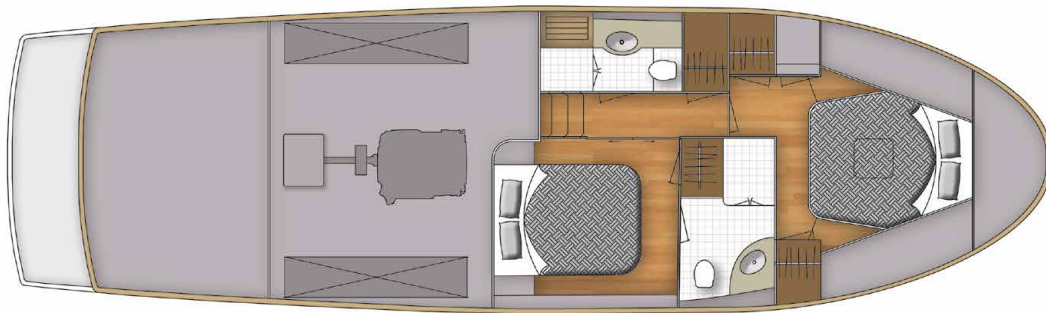
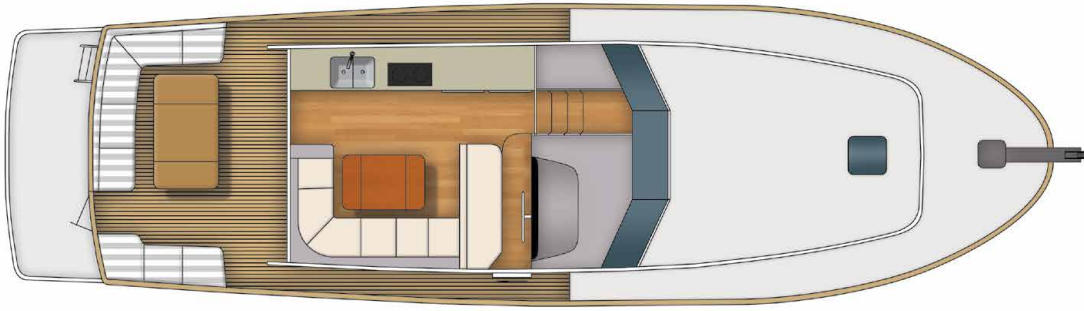

490GRANDSEDAN

Length Overall (inc, swim platform)	14.5m (47' 5")
Beam	4.3m (14' 1")
Maximum Draft approx	1.3m (4' 2")
Sleeping Capacity	6 person
Fuel Capacity approx.	2,000 litres
Water Capacity approx.	700 litres
Holding Tank Capacity approx.	200 litres
Engine	Volvo D6 435hp



INTEGRITY
MOTOR YACHTS

DISCOVER MORE

Version: 10/07/2019

340SEDAN 340SX 380SEDAN 380SX 440SEDAN 440FB 460SX 490GRANDSEDAN 510SX

QUEENSLAND
Integrity Motor Yachts
Jason Kowalski 0416 057 326

NEW SOUTH WALES
AWMarine Sales
Adam Workman 0419 124 939

VICTORIA
Pier 35 Boat Sales
Terry Ryan 0422 666 212

WESTERN AUSTRALIA
Martin Box Marine
Phone 08 9336 1466

www.integrityboats.com.au

490GRANDSEDAN

BASE SPECIFICATION

MECHANICAL & ELECTRICAL

Acoustic and thermal insulation throughout engine room
Non-skid flooring in engine room
Freshwater cooling on engine
Engine alarm system
Racor fuel filter
Anti-vibration engine mounts
Fibreglass exhaust system for engine
Fibreglass Aqualift exhaust for generator
Ventilation system includes blowers for engine room
Stainless steel propeller shaft
Dripless PSS shaft seal
Steering stock
Rudder locking pin
Bronze propeller
Bronze Seawater strainers for engine, genset & aircon
Bow Thruster 24V 8HP
Stern Thruster 24V 8HP
Full keel, GRP Rudder
All hoses double hose clamped below waterline
Ball valves on all seacocks and skin fittings
Hot water heater 40 Litres
Bilge pumps auto with manual override and high water alarms x 3
Manual bilge pump system
Fresh water pressure pump high volume 24v
Seawater pump for foredeck and cockpit 24v
Sanitation system with macerator pump out and deck fitting for dock side pump out
Generator 9kW
Battery charger/inverter 24v 3kva
House Batteries- 400Ahr 24VDC, maintenance free
Engine Batteries -110Ahr 24VDC, Genset Battery 110Ahr 24VDC
All batteries fitted in battery boxes
Battery paralleling system for emergency engine start
LED lighting throughout 24v
Engine room lighting DC
Navigation lights LED international compliant
All AC power outlets RCD protected
Bonding system to hull fittings, zinc anode incl. isolator
Tinned electrical wiring. Where applicable coded and labelled
Electrical panel DC with circuit breakers.
Shore power lead 1 x 15 Amp

Fusion Stereo with bluetooth

Fusion speakers

SALOON HELM

Helm bench seat, including footrest and storage underneath

Console for instruments

Full engine controls, compass, anchor winch controls

Safety monitor panel for bilge pumps, sump pump

Stainless steel steering wheel leather wrapped

VHF radio with aerial

Horn electric

Hydraulic steering

Fuel and Water gauges

STATEROOM - FORWARD

Flooring high quality vinyl

Double berth with foam mattress

Hanging locker

Escape deck hatch from forward cabin stainless steel

Ocean air hatch cover with screen and blind

Reading and overhead lighting LED 24v (DC)

Private entrance door

Storage under berth

Opening porthole stainless steel x 2

STATEROOM - MIDSHIPS

Private ensuite with shower

Flooring high quality vinyl

Double berth with foam mattress

Hanging locker

Opening porthole stainless steel

Reading and overhead lighting (DC)

Private door entrance

Storage under berth

Storage locker drawers

Mirror

Hanging locker with drawers

CONSTRUCTION

Moulded GRP hull white gelcoat

Hull top sides reinforced for light weight

Independent compartments and stringer system



DISCOVER MORE

Version: 10/07/2019

340SEDAN

340SX

380SEDAN

380SX

440SEDAN

440FB

460SX

490GRANDSEDAN

510SX

QUEENSLAND
Integrity Motor Yachts
Jason Kowalski 0416 057 326

NEW SOUTH WALES
AWMarine Sales
Adam Workman 0419 124 939

VICTORIA
Pier 35 Boat Sales
Terry Ryan 0422 666 212

WESTERN AUSTRALIA
Martin Box Marine
Phone 08 9336 1466

www.integrityboats.com.au

490GRANDSEDAN

BASE SPECIFICATION

Solid hull bottom with chines to waterline
Vinyl ester resin used in first two outer layers of hull
Water tight collision bulkhead forward
Water tight light weight cored bulkheads/flooring
White hull colour standard/inc boot stripe

DECK

Anchor 45lbs, 60mtrs of chain
Anchor locker accessed by 2 hatches on deck
Anchor safety strap
Bow rail welded stainless (316) flag staff at bow
Bow roller stainless self loading
Cleats stainless steel x 6, (Bow x 2, Spring x 2, and Stern x 2)
Docking lines and fenders x 4
Escape deck hatch from forward cabin stainless steel
Exterior courtesy deck lights
Fuel fillers on side decks
Fwd windscreen in safety glass bonded to FRP frames
Rub Rail with stainless steel insert
Winch 24V with foot switches
Non slip on fwd & deck sides
Sliding Side door to FRP house frame
Stainless steel swim ladder
Wash down tap (sea water & fresh) in anchor locker

COCKPIT

Aft seat with teak table
Access hatch lockable
Flood lights, overhead lighting & courtesy DC
Hand held shower hot/cold
Stainless framed main saloon entrance door with hopper window
Stainless steel grab rails
Teak laid cockpit floor
Wash down tap, fresh water
Cockpit storage under seating
GRP 1200mm swim platform with teak inserts
Shore power inlet located in cockpit locker

HEAD

Private entrance door
Overhead and vanity lighting LED 24v (DC)
Opening porthole stainless steel
Solid benchtop surface including basin and single lever faucet
Extraction fan
Shower stall with glass door with automatic sump pump
Shower rose
Mirror
Fresh water flush toilet
Toilet roll holder
Towel rail

SALOON & GALLEY

Tinted opening glass saloon windows
Electric hot plate (2 x burner) cover and recessed
Microwave -powered off inverter
Refrigerator and Freezer (DC) underbench x 2
Galley benchtop solid surface, stainless steel twin sink with single lever faucet
Sink and cooktop cover recesses in benchtop
Galley storage cabinets and soft close drawers
Headliner in high quality vinyl
LED lighting overhead 24v
L-Shaped saloon lounge with timber table and storage
Flooring high quality vinyl
Blinds (selected from samples)

INTERIOR

High quality vinyl flooring in saloon and companionways and cabins
Vinyl headliner covered ceiling with wood trim design features
Teak Timber satin finish



DISCOVER MORE

Version: 10/07/2019

340SEDAN

340SX

380SEDAN

380SX

440SEDAN

440FB

460SX

490GRANDSEDAN

510SX

QUEENSLAND
Integrity Motor Yachts
Jason Kowalski 0416 057 326

NEW SOUTH WALES
AWMarine Sales
Adam Workman 0419 124 939

VICTORIA
Pier 35 Boat Sales
Terry Ryan 0422 666 212

WESTERN AUSTRALIA
Martin Box Marine
Phone 08 9336 1466

www.integrityboats.com.au

490GRANDSEDAN

OPTIONS & PRICING

INTEGRITY 490 GRAND SEDAN STD ENGINE

Volvo D6 435hp..... Priced from **\$999,000**

OPTIONS AVAILABLE

Chain Counter	\$1,020.00
Roof Ladder	\$1,630.00
32-inch flat screen TV, antenna, brackets and installation	\$1,290.00
Electric TV 32" lifter to saloon	\$1,315.00
Décor and soft furnishing package	\$6,680.00
12,000btu Air-conditioning lower cabins	\$7,815.00
16,000btu Air-conditioning to Saloon/Galley.....	\$9,511.00
Gloss Timber Finish	\$6,650.00
Search Light with remote at helm.....	\$1,710.00
700W 4 panel solar system	\$7,300.00
Latex mattress upgrade - Single bed	\$1,630.00
Latex mattress upgrade - Queen bed	\$1,937.00
Teak & Holly style high quality vinyl flooring.....	\$4,755.00
Thruster upgrade Bow and Stern to 8HP	\$5,390.00
Additional Waeco fridge underbench in galley	\$3,260.00
Full all weather cockpit covers and clear side doors.....	\$5,200.00
Breezeway covers to side and from windows in black mesh	\$1,890.00
Waeco 75L fridge in cockpit locker	\$3,060.00
Twin stainless steel BBQ rail on swim platform.....	\$2,993.00
Gas BBQ with 4.5kg fibreglass bottles x2	\$2,310.00
Underwater Lights x 2	\$3,110.00
Swim platform centre rail.....	\$1,495.00
Upgrade to twin deluxe helm chairs	\$4,890.00

This Specification and Price is subject to change without notice.

Pricing is in AUD Dollars. Valid until 31/12/2019



INTEGRITY
MOTOR YACHTS

DISCOVER MORE

Version: 10/07/2019

340SEDAN

340SX

380SEDAN

380SX

440SEDAN

440FB

460SX

490GRANDSEDAN

510SX

QUEENSLAND
Integrity Motor Yachts
Jason Kowalski 0416 057 326

NEW SOUTH WALES
AWMarine Sales
Adam Workman 0419 124 939

VICTORIA
Pier 35 Boat Sales
Terry Ryan 0422 666 212

WESTERN AUSTRALIA
Martin Box Marine
Phone 08 9336 1466

www.integrityboats.com.au

THE INTEGRITY ADVANTAGE

There are a number of things that we believe make our boats leaders in their market. All of these features have been considered, designed and implemented to make your boating experiences more enjoyable. Introducing the integrity advantage.

CLASSIC STYLISH LINES WITH A CONTEMPORARY FEEL

The inspiration for our range comes from the traditional cruising motor yacht, featuring timeless classic lines. We apply contemporary design elements to ensure our range have a striking on water appearance.

PROVEN DISPLACEMENT HULL WITH CLASS LEADING BEAM

With a number of our boats having travelled many thousands of sea miles, the seakeeping abilities of our range is without question. The class leading beam ensures stability in all conditions, particularly when at rest. The displacement hull, greater beam, full length keel and additional weight ensures navigational stability in all seas or when at rest.

MINIMAL HULL SLAP

A little thought about but very important feature, as anyone that has tried to sleep in a boat with water slapping under the hull knows is most annoying. Our boats have no planing strakes meaning no slap at rest.

SOLID HAND LAID FIBREGLASS HULLS FOR STRENGTH AND DURABILITY

Our hulls are laid up to survey standard along with vinyl ester tie layers for strength, durability and osmosis protection. FGI Gelcoat is used on the exterior of the hulls especially applied to suit Australian conditions.

FULL LENGTH KEEL ENCASING THE PROPELLER AND RUDDER

The full length keel assists with stability while offering protection to the propeller and rudder. Should you run aground, simply back off and continue your journey.

EASY TO HANDLE WITH EFFORTLESS DOCKING

Bow and stern thrusters as standard on each model offer finger-tip control ensuring simple and easy berthing in all conditions. The helm door and through rail access makes

single handed step on - step off berthing a breeze. Side rail and stern access from the swim platform means marina and jetty access is safe and simple, no leaps of faith required.

360 DEGREE WIDE WALK AROUND DECK

There is full easy access to all areas of the boat, with wide side decks and high bow, stern and hand rails ensuring safety for passengers and pets at anchor or underway.

LARGE SWIM PLATFORM

The extensive swim platform features a sturdy deep water ladder, plus retractable hot and cold freshwater shower. Stainless stern rails can be added to house BBQ's or preparation boards, tenders and rod holders.

INNOVATIVE COCKPIT DESIGN

The beamy cockpit layout features full wrap around padded seating with a drop down teak table, creating additional accommodation or a day bed along with under-seat storage and self-draining ice box. Combines with the large hopper window and door, spacious saloon and aft galley to create the ultimate entertaining layout. The ice box can also be converted to take a portable 55 or 75 litre Waeco fridge/freezer.

GENERATOR AND REVERSE CYCLE AIR-CONDITIONING

Onan diesel powered generator offered standard allowing for all of your 240V electricity needs including coffee machine, toaster, juicer, hair dryer and more. Ducted air-conditioning is available offering cold and hot air during temperate or cooler climates.

LARGE STAINLESS STEEL HOPPER WINDOW AND DOOR

Critical to creating the flowing cockpit, galley and saloon layout, the sturdy stainless steel hopper window and door is a trademark feature of our range. Each model benefits from this design trademark.



INTEGRITY
MOTOR YACHTS

DISCOVER MORE

340SEDAN 340SX 380SEDAN 380SX 380FB 440SEDAN 440FB 460SX 490GRANDSEDAN 510SX

QUEENSLAND
Integrity Motor Yachts
Jason Kowalski 0416 057 326

NEW SOUTH WALES
AWMarine Sales
Adam Workman 0419 124 939

VICTORIA
Pier 35 Boat Sales
Terry Ryan 0422 666 212

WESTERN AUSTRALIA
Martin Box Marine
Phone 08 9336 1466

www.integrityboats.com.au

WELL APPOINTED AFT GALLEY

Large fridges, double bowl sink with flick mixer, modern corian style bench tops, microwave and glass twin top hotplate are just the start. Considerable storage is a feature along with additional refrigeration options.

SPACIOUS ACCOMMODATION

Recent design improvements have led to more spacious and roomy accommodation in the bedrooms, featuring full size comfortable island beds. The saloon and cockpit tables lower to create additional double bed accommodation across the range. Cedar lined full length cabinets ensure your clothing is stowed moisture and pest free.

SEPARATE HEAD AND SHOWER COMPARTMENT

Rarely offered in boats of this size, a separate shower ensures little water splash throughout the bathroom and more room to enjoy your shower. Offers privacy for those using the shower or toilet.

ALL WEATHER COCKPIT COVERS

Full insect and weather covers are fitted to the cockpit and side decks. When in place, limits weather in the cockpit and creates an additional enclosed living area.

RELIABLE FUEL SUPPLY SYSTEM

Racor fuel filters with isolation taps are fitted to bypass blocked filters and reduce the chance of contaminated fuel. Separate ball valves are installed to assist the return or transfer of fuel, and sludge tanks with ball valves for ease of draining are included in the fuel tanks.

LONG RANGE CRUISING WITH LARGE WATER AND FUEL CAPACITY

The long-range performance, economical and mechanical capabilities of our range is supported by considerable fresh water storage and saltwater wash down facilities. Large fuel tanks are also on board, with the option of adding a water maker to extend the cruising capability.

INNOVATIVE ELECTRICAL SYSTEM MANAGEMENT WITH SOLAR

With advancements in solar capabilities and advanced power management systems, your Integrity when fitted with solar can operate for lengthy periods without the need for shore power or generator.

FACTORY BACKED DEALER NETWORK

We maintain Independent Dealers in all major territories, offering full warranty and service support. We appreciate the opportunity to assist our owners with whatever little headaches may arise, and we never let them down.

MORE THAN OWNING A BOAT

Rather than focusing on selling a product, we prefer to introduce our owners to the ultimate lifestyle experience. We offer a series of on-water and off-water events exclusive to those who purchase a boat from our range. Fully escorted trips allow our owners to expand their navigational and boating experiences in the company of other owners and our experienced team members.

INVESTMENT IN A TRUSTED BRAND

Integrity Motor Yachts is the leading displacement motor yacht brand in Australia. With over 100 motor yachts sold and the backing of a dealer network, there's certainty in knowing you're investing in a known and well respected brand with strong resale value.

2018-2019 PRODUCT ENHANCEMENTS

- Rudder locking pin
- 24 Volt DC system including all pumps etc on vessels 46ft and larger
- Upgraded bow and stern thrusters on boats 38ft and larger
- Double hose clamps on all hoses
- 3000Va Inverter 70 Amp charger system with mains changeover
- Battery relocation for practicality
- 400 Ah of batteries at 24 VDC
- 60 metres of anchor chain
- Fresh and salt water washdown taps in anchor well
- All AC outlets RCD protected
- Shore power inlet now protected in cockpit locker
- 32 Amp and 15 Amp shore power capability
- Fusion stereo/DVD with Bluetooth
- Stainless steel hatches



INTEGRITY
MOTOR YACHTS

DISCOVER MORE

340SEDAN 340SX 380SEDAN 380SX 380FB 440SEDAN 440FB 460SX 490GRANDSEDAN 510SX

QUEENSLAND
Integrity Motor Yachts
Jason Kowalski 0416 057 326

NEW SOUTH WALES
AWMarine Sales
Adam Workman 0419 124 939

VICTORIA
Pier 35 Boat Sales
Terry Ryan 0422 666 212

WESTERN AUSTRALIA
Martin Box Marine
Phone 08 9336 1466

www.integrityboats.com.au